

DR5 Duster

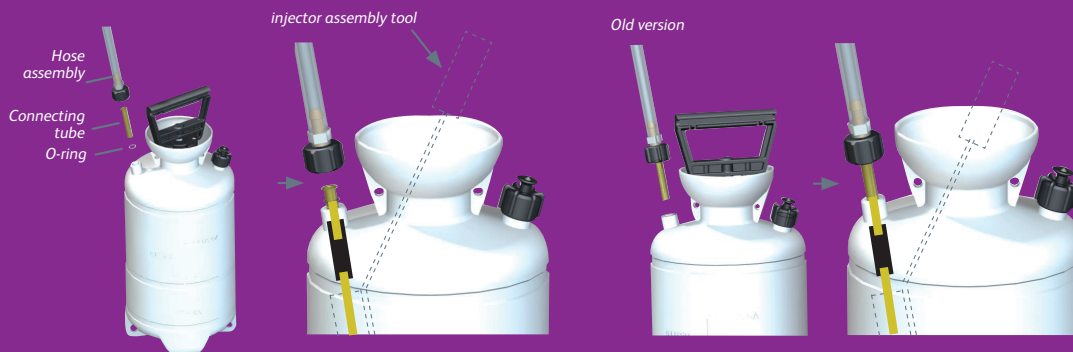

DR5 Duster hints and tips

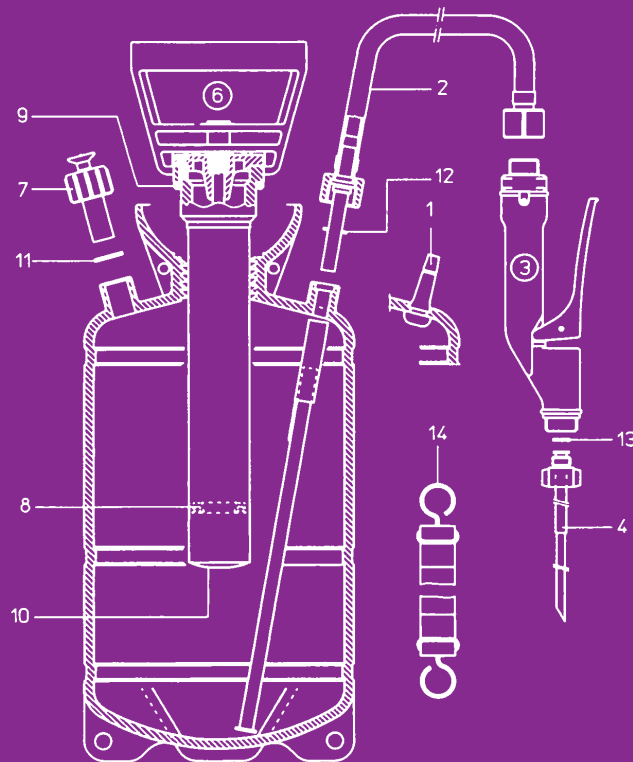

Collect 2 points for every £1 you spend!
TERMS AND CONDITIONS APPLY

DR5 Duster

DR5 DUSTER HINTS & TIPS

As the wasp season is in full swing, it pays to give your DR5 Duster some tender loving care to keep it in the best possible shape. PCN has compiled some handy hints and tips to help you keep this kit in tip top condition. It is worth remembering that you cannot treat wasp nests with a poorly maintained duster.

The manufacturers instructions for the DR5 instruct you to empty the duster after use and never store powder in the appliance. The reason for this is to prevent any clumping of powder and therefore blockages occurring, due to moisture accumulation in the DR5. Any busy pest controller will know that emptying the DR5 isn't always possible. So, what else can be done to prevent clumping of powder and subsequent blockages?

PREVENT CLUMPING OF POWDER

- Put a golf ball in the tank of the DR5, to stimulate movement of dust.
- Do not store your DR5 in your van overnight, as condensation is problematic. Store in a heated pesticide storeroom.

DEALING WITH BRASS INJECTOR ISSUES

- Use a DR5 with the latest hose assembly modification, with connecting tube and O-ring. With the new two piece hose assembly, the hose can be removed easily without needing to reassemble the inside brass injector (aka 'dip tube').
- If you have a DR5 without the latest hose assembly modification, the brass injector may become dislodged. Use a DR5 tool to re-attach it.
- If the brass injector becomes blocked with powder, remove it and tap it firmly on a hard surface to dislodge dust.

LOSS OF PRESSURE

- A common complaint is a loss of pressure. Try removing the valve gasket and clean it with a stiff dry toothbrush to remove any dust. Or, just replace the valve gasket.

GENERAL MAINTENANCE

- If any part shows wear and tear, replace it immediately.
- Pay particular attention to gaskets, which are prone to wear and tear and can be replaced easily. Keep a seal kit handy!
- Use only original Birchmeier replacement parts!
- Store the DR5 away from the effects of frost.
- Screw the pump in loosely when the appliance is not in use.
- Use a foot pump (dry air) attached to the schrader valve to pressurise the DR5 and save on 'elbow grease' required for manual pumping.
- Never use damp air (e.g. air compressors at a garage) to pressurise the DR5.

FIG. NO.	DESCRIPTION	PART NO.
1	Valve	501 375 31
2	Hose complete	114 782 02
3	Control valve complete	104 950 07A
4	Brass wand	114 221 01
5	Wand connector	113 418 01
6	Pump complete	116 255 01
7	Pressure relief valve 3 bar	116 179 01
*	Gasket set	116 298 01
	Parts marked with an asterisk only included in this set.	
8*	Sleeve (Pack of 6)	116 427 01
9*	O-ring 50.16 x 5.34	
10*	Valve gasket	
11*	Gasket 21/15.4 x 2	
12*	Gasket 15/5.5 x 2	
13*	Gasket 11.9/7 x 1	
14	Shoulder-strap	104 536 01
15	Crack & crevice tip	114 350 01
	DR5 Maintenance Tool	DR5TOOL



Collect 2 points for every £1 you spend!
TERMS AND CONDITIONS APPLY

Killgerm Chemicals Ltd., P.O. Box 2, Ossett, W. Yorks. WF5 9NA.

☎ 01924 268420 📠 01924 264757 ✉ sales@killgerm.com 🌐 www.killgerm.com